



## Predĺženie promenády na Železnej studničke

**What Architects.**

3:0 | LANDSCHAFTS  
ARCHITEKTUR

**PROKOS, s.r.o.**



rybník



mokrad'



lúka



les

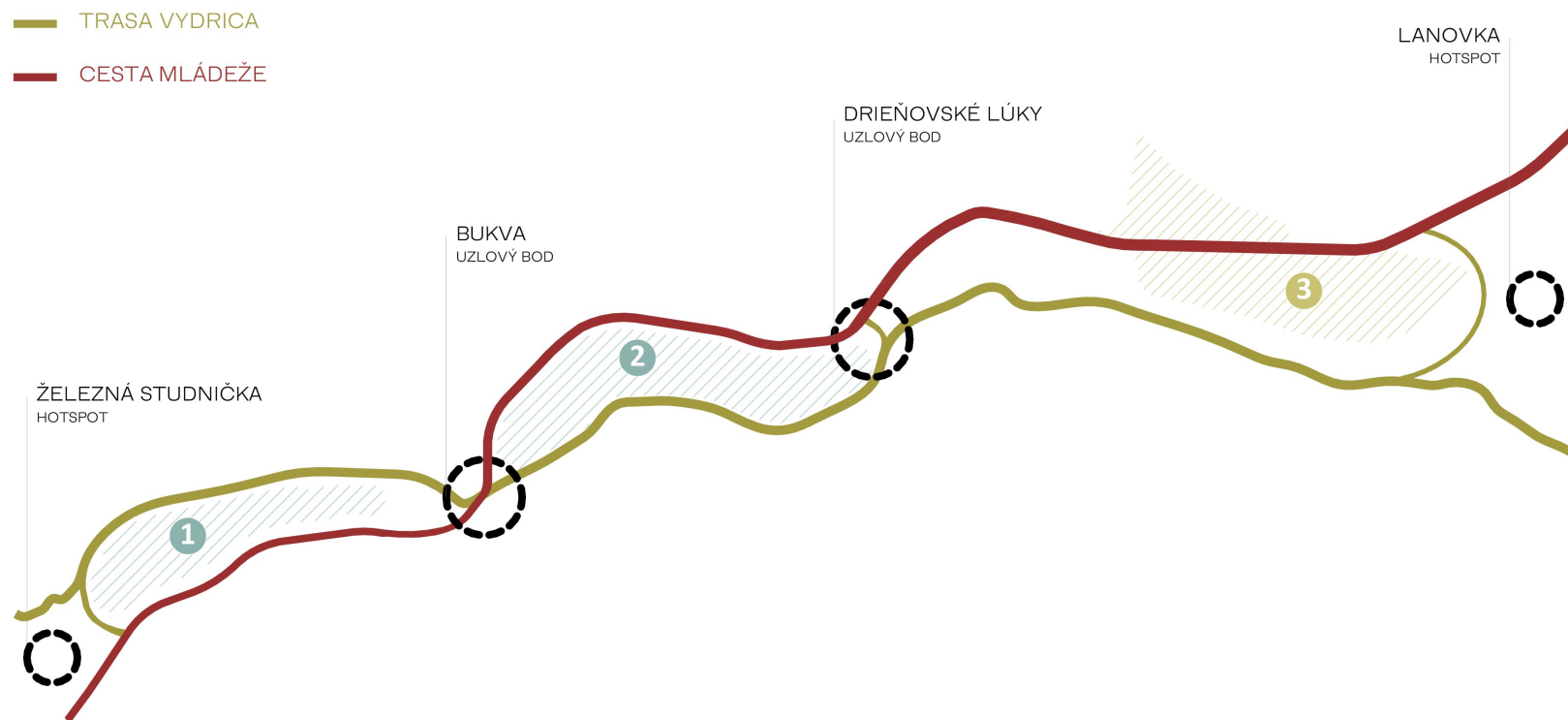

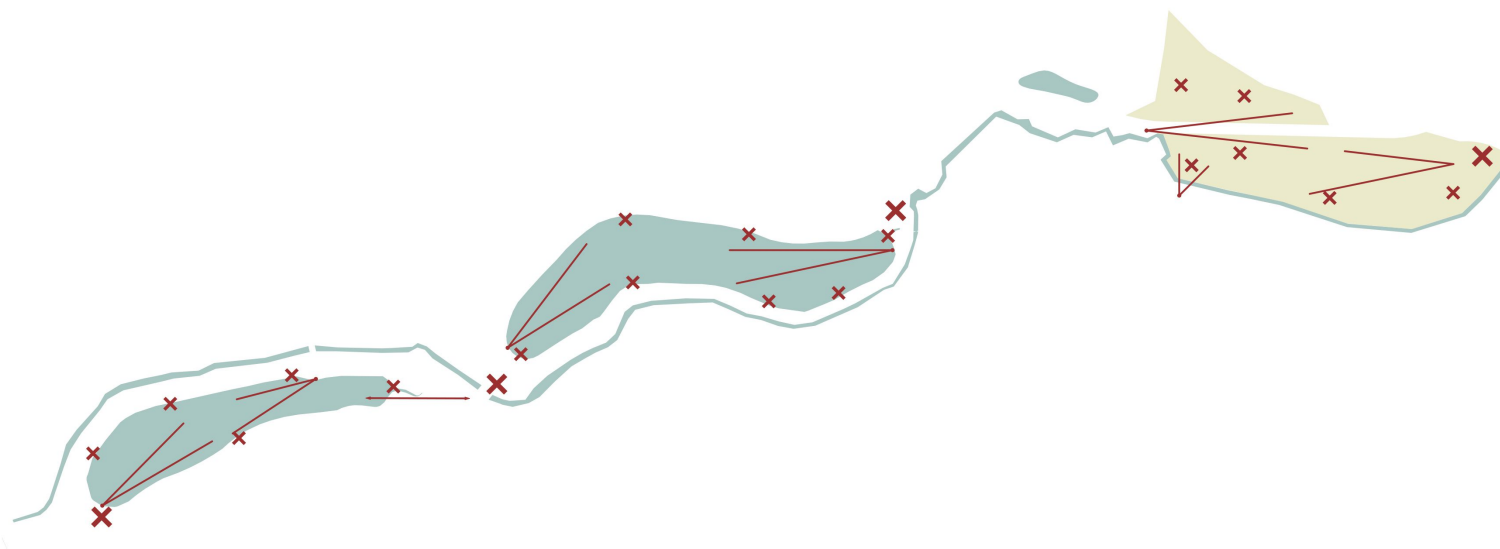



PRIEREZY  
vytváranie priehľadov v  
jestvujúcej krajine



PRIEHLADY  
vytváranie otvoru /  
definovanie výhľadu

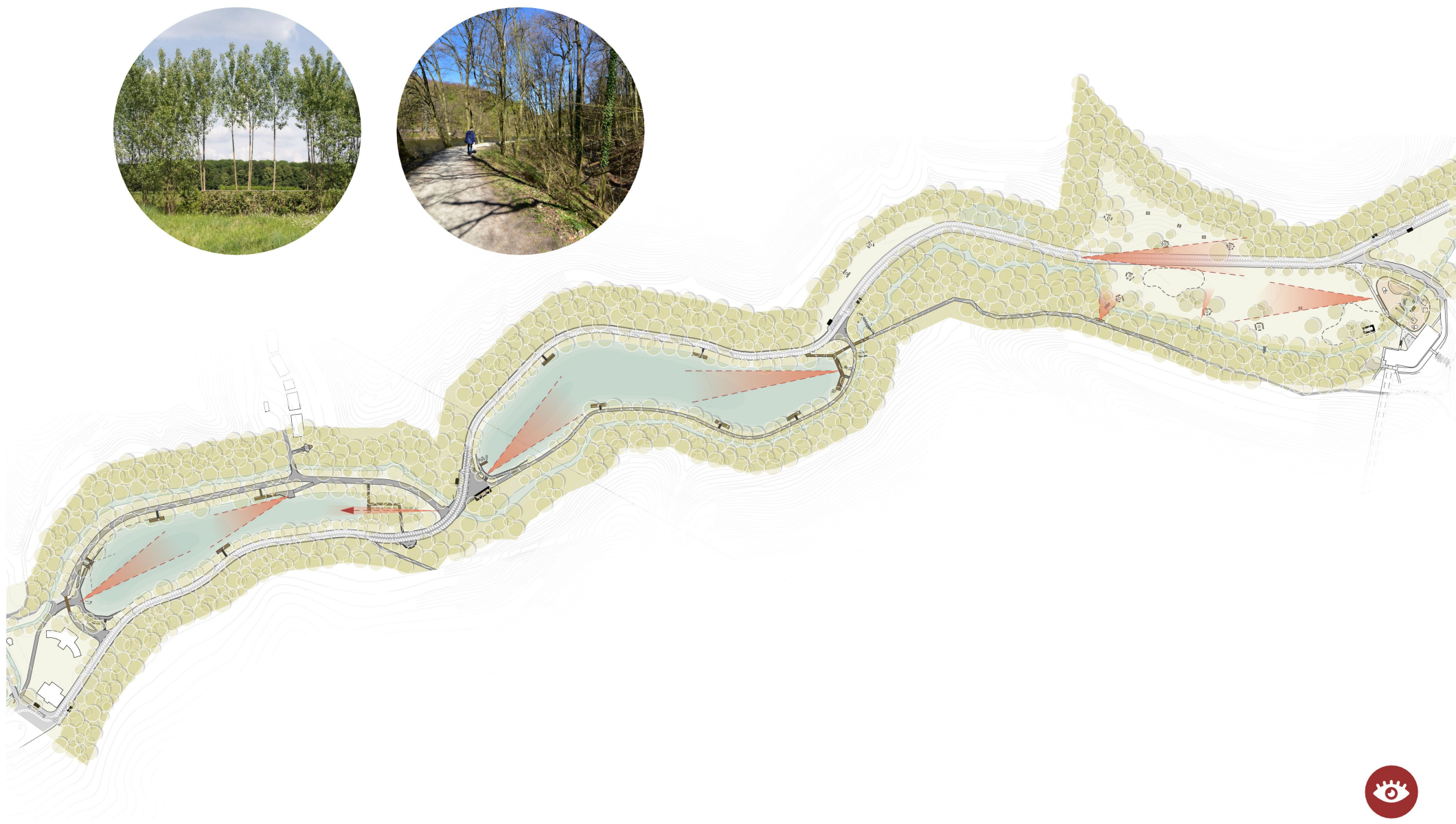







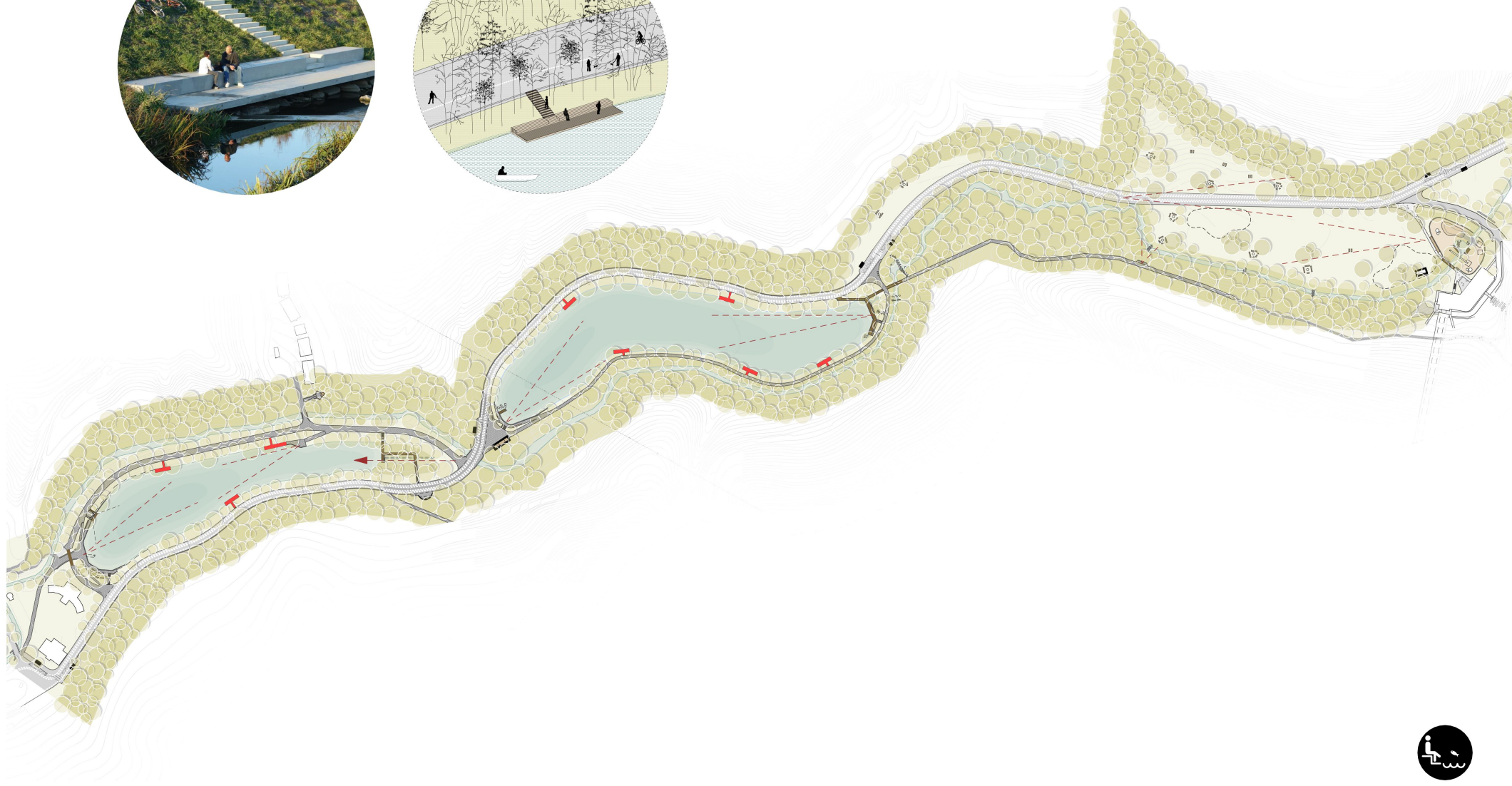
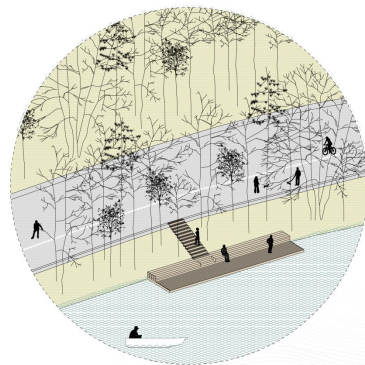



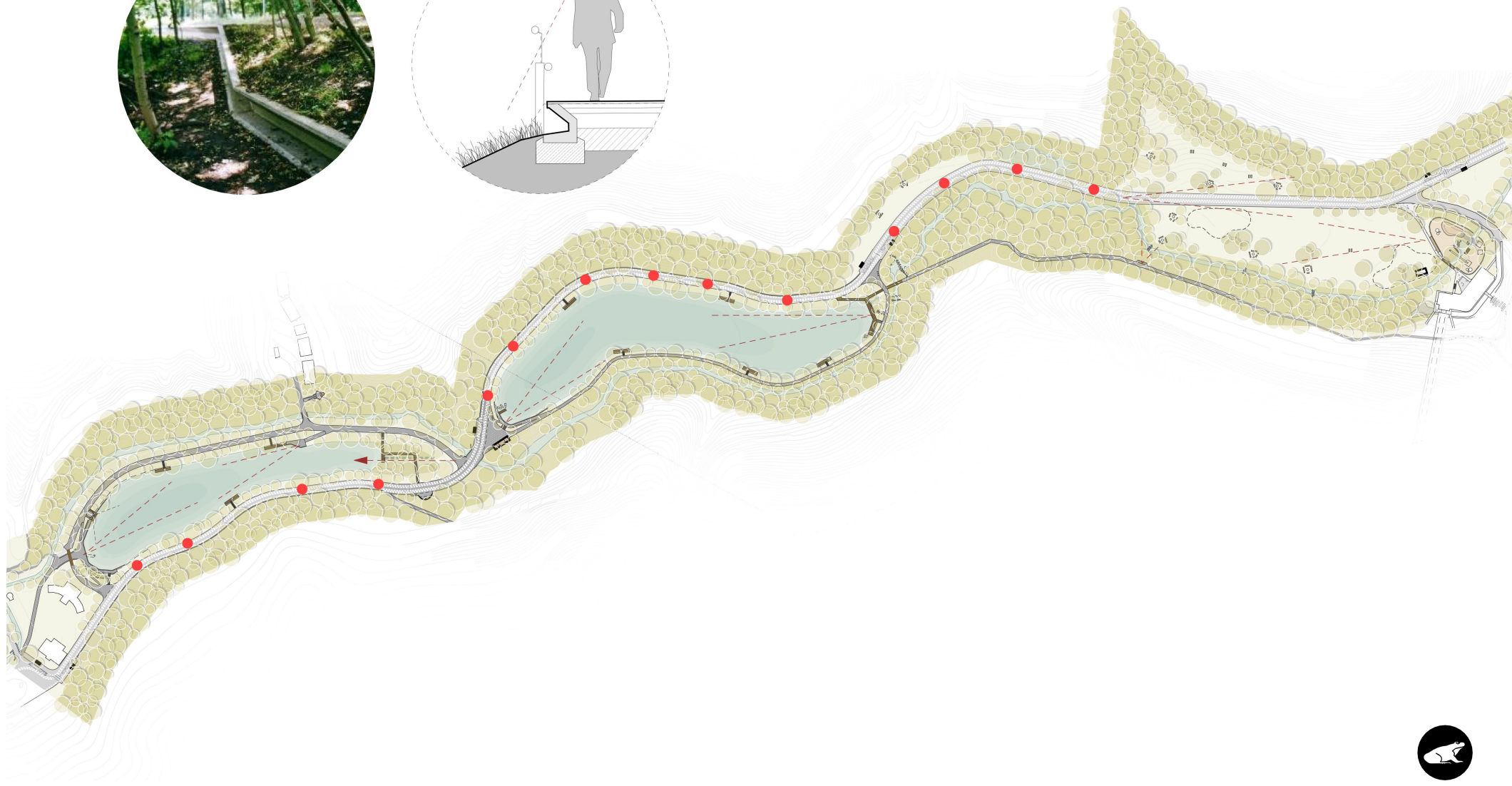
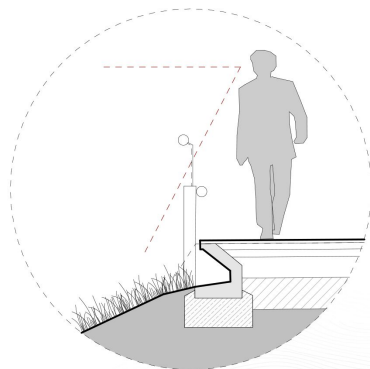

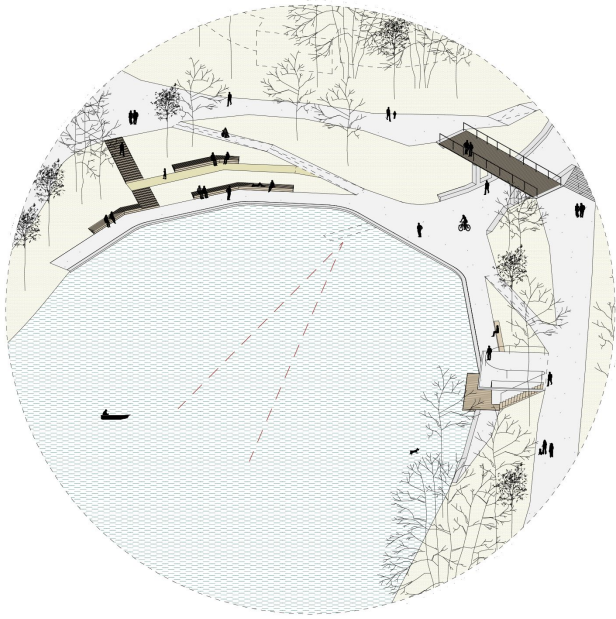

bezbarierový prístup k vode

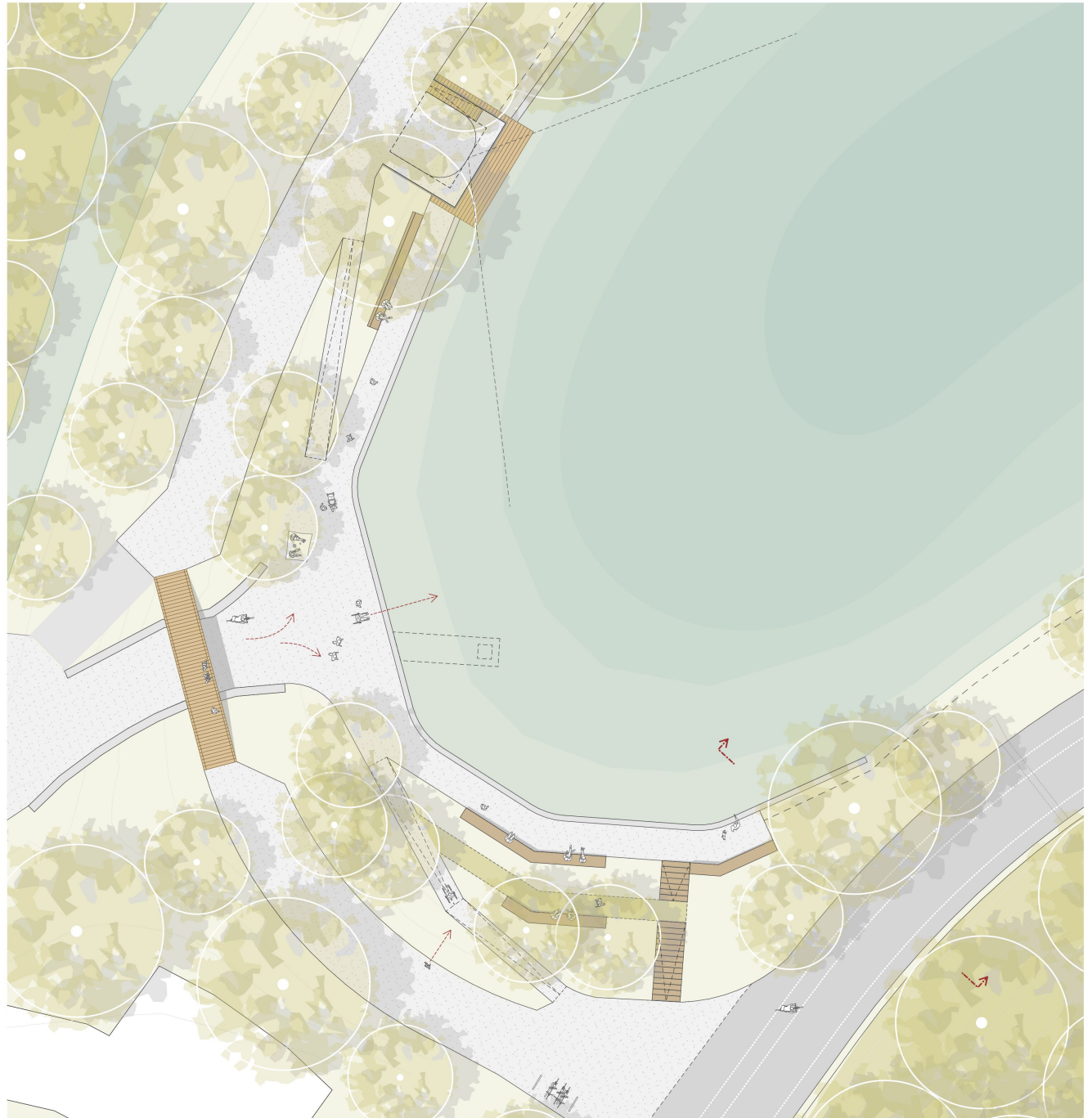

Začiatok rybníka II.





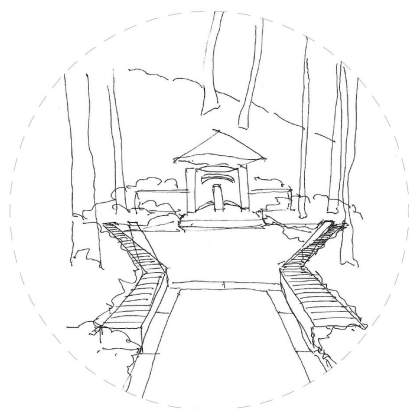
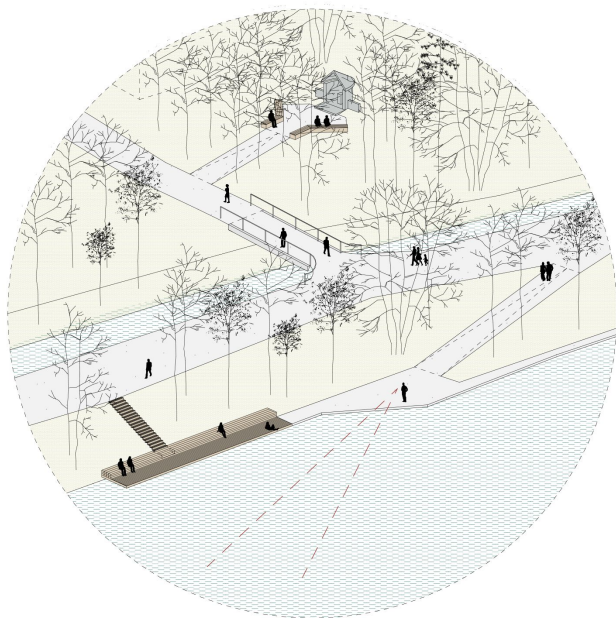

kaplnka

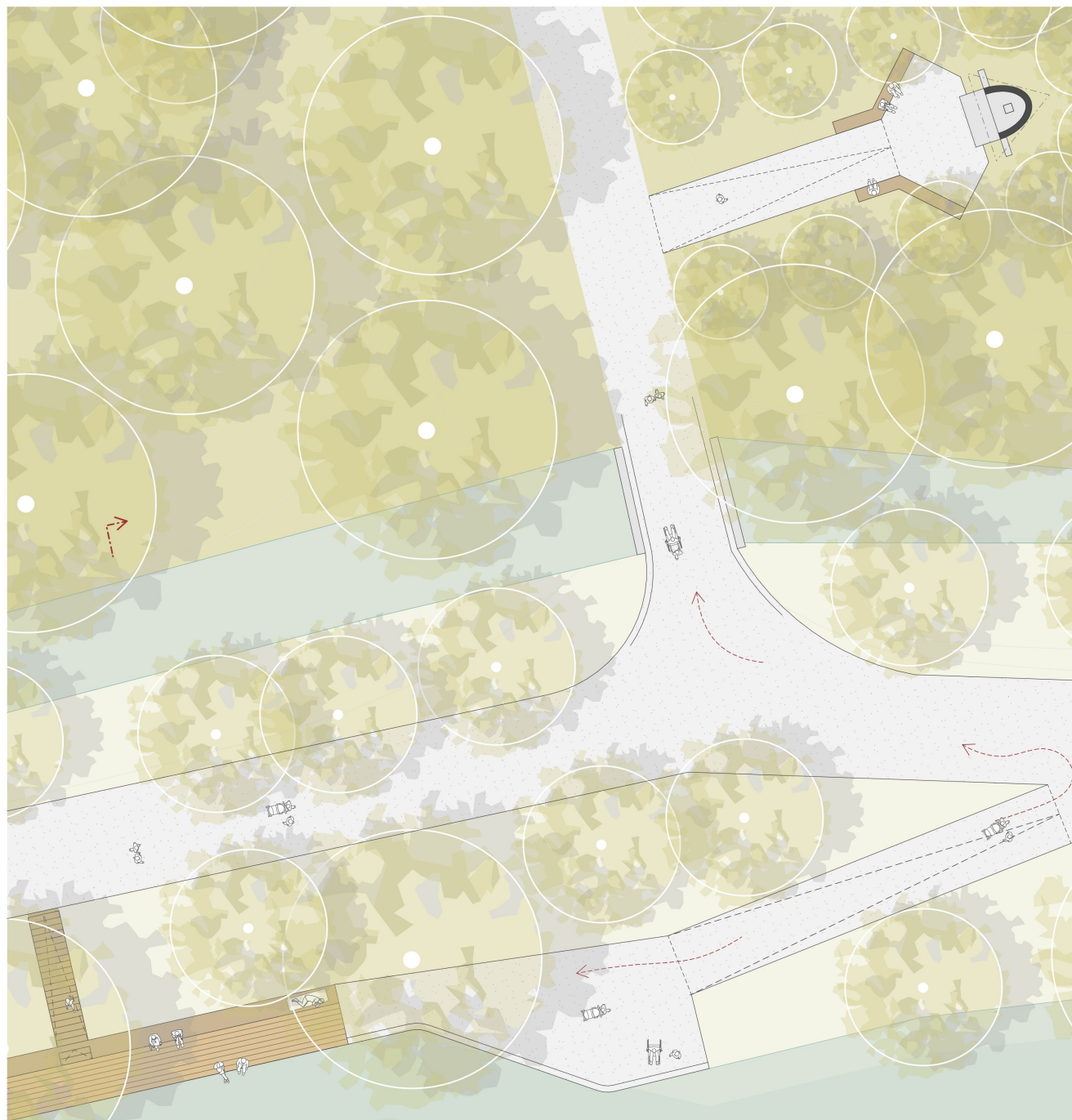

Kaplnka - mólo

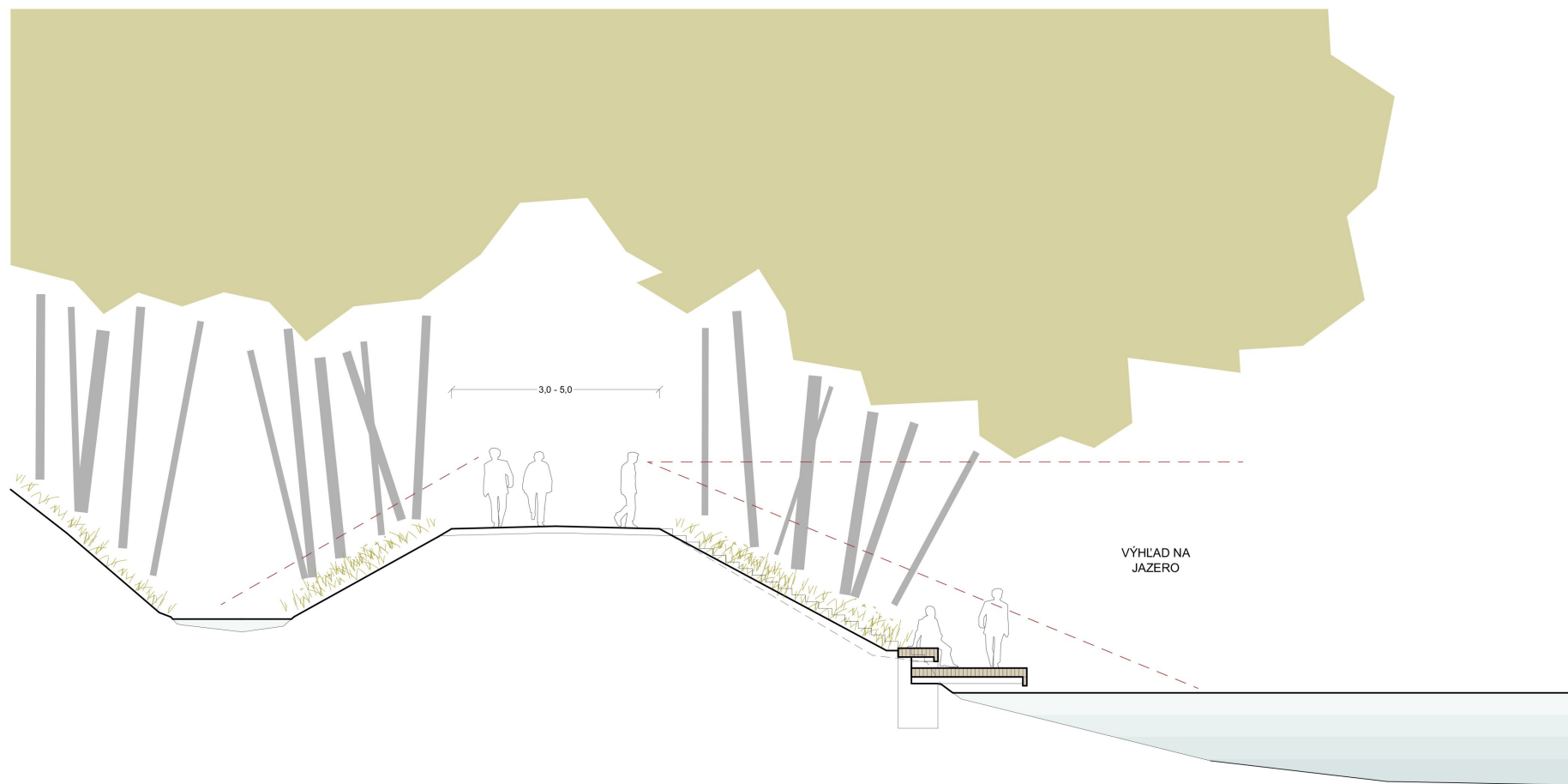



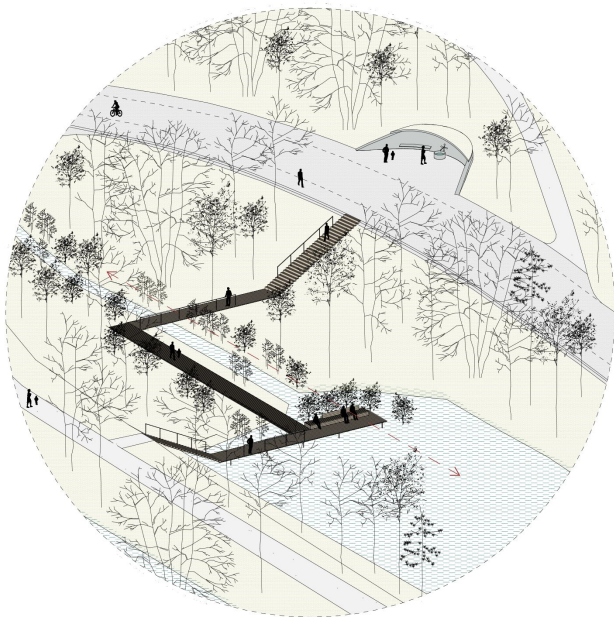

lávka cez mokrad'

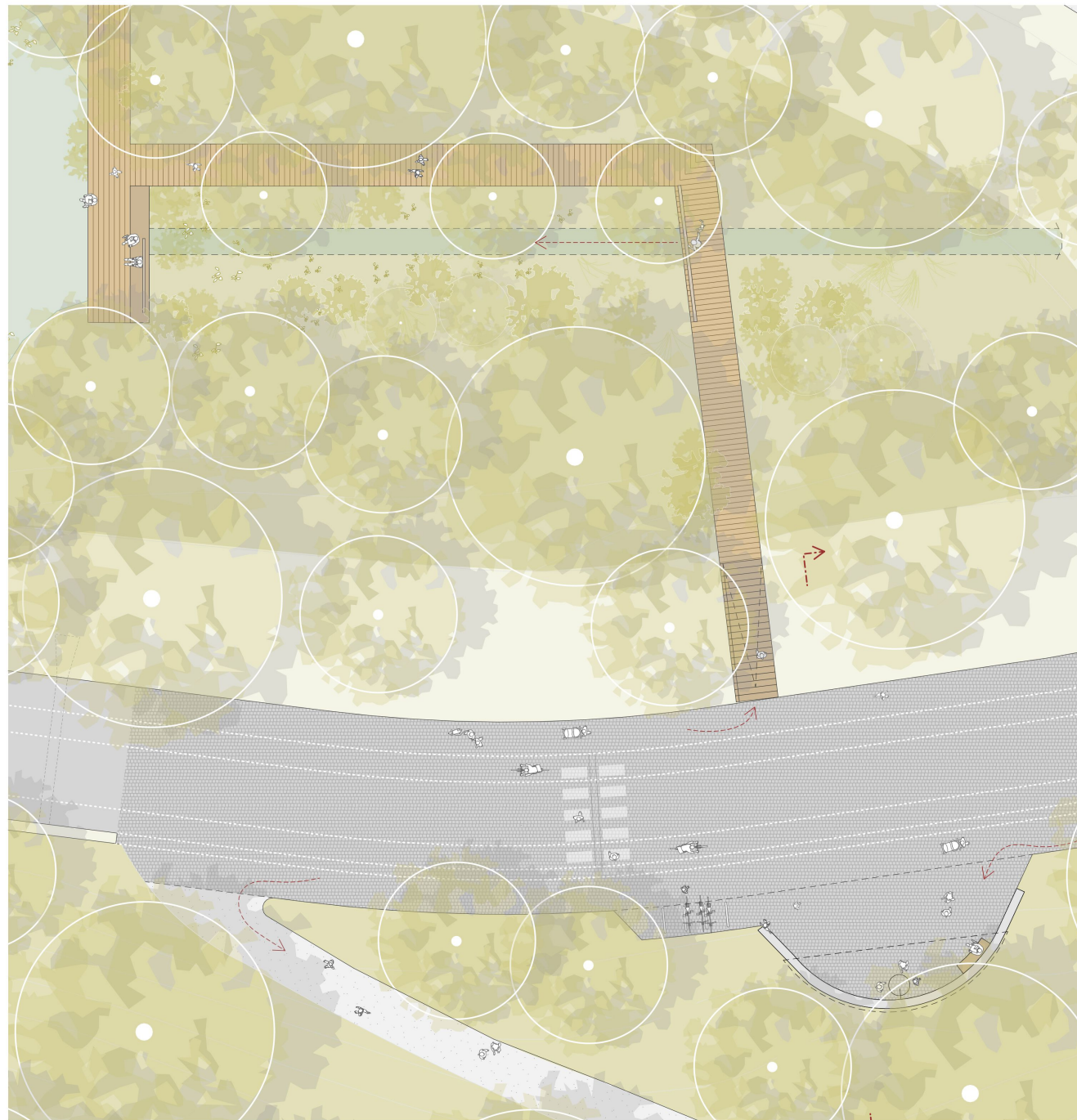

Prameň - lávka





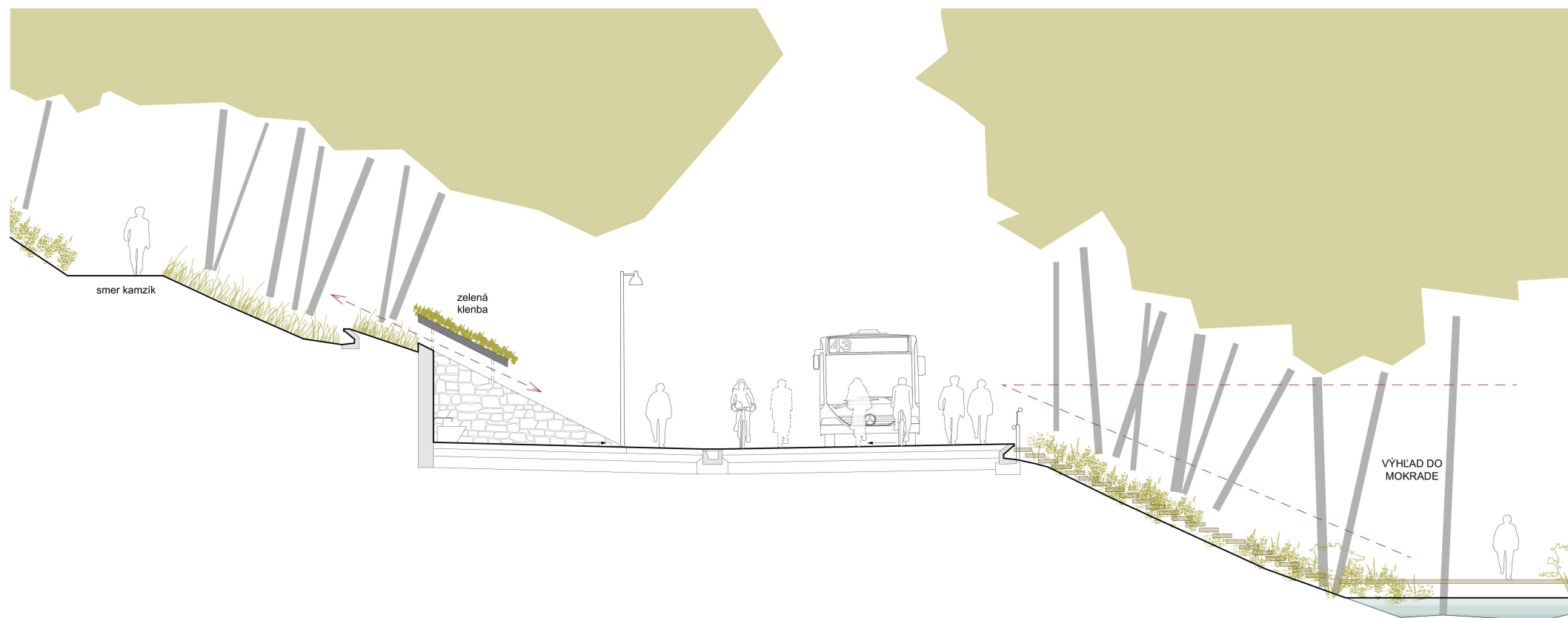

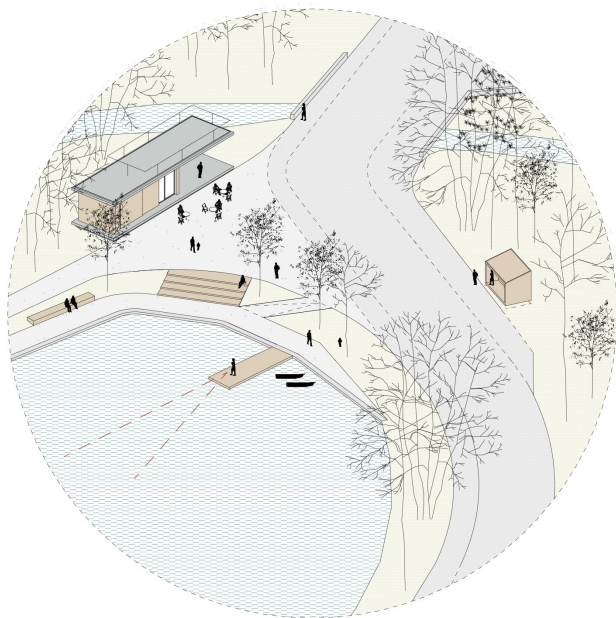

návrat člnkovania na rybníkoch



Začiatok rybníka I.





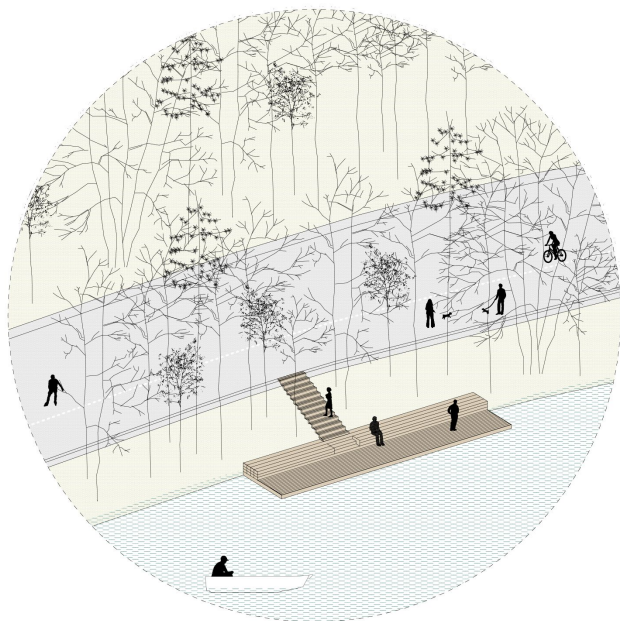

mólo pri vode



Prístup k vode



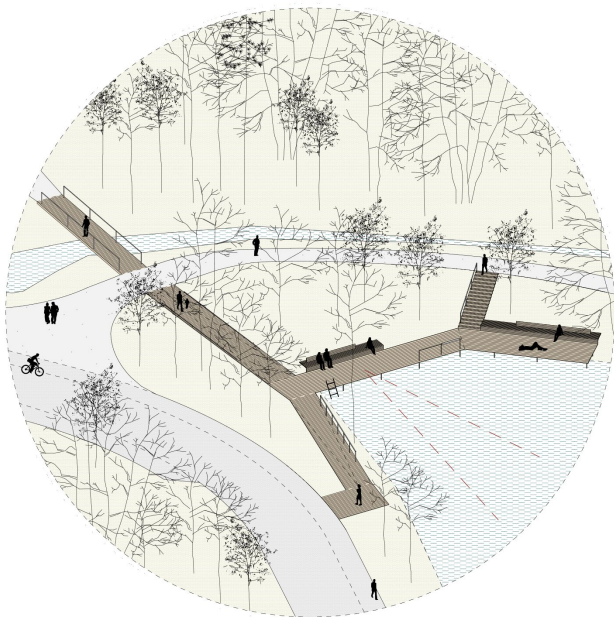

móla pri vode



Koniec rybníka I. - lávka







příklad ohniska



sedenie pri ohnisku



drevené zábradlie - výhliadka

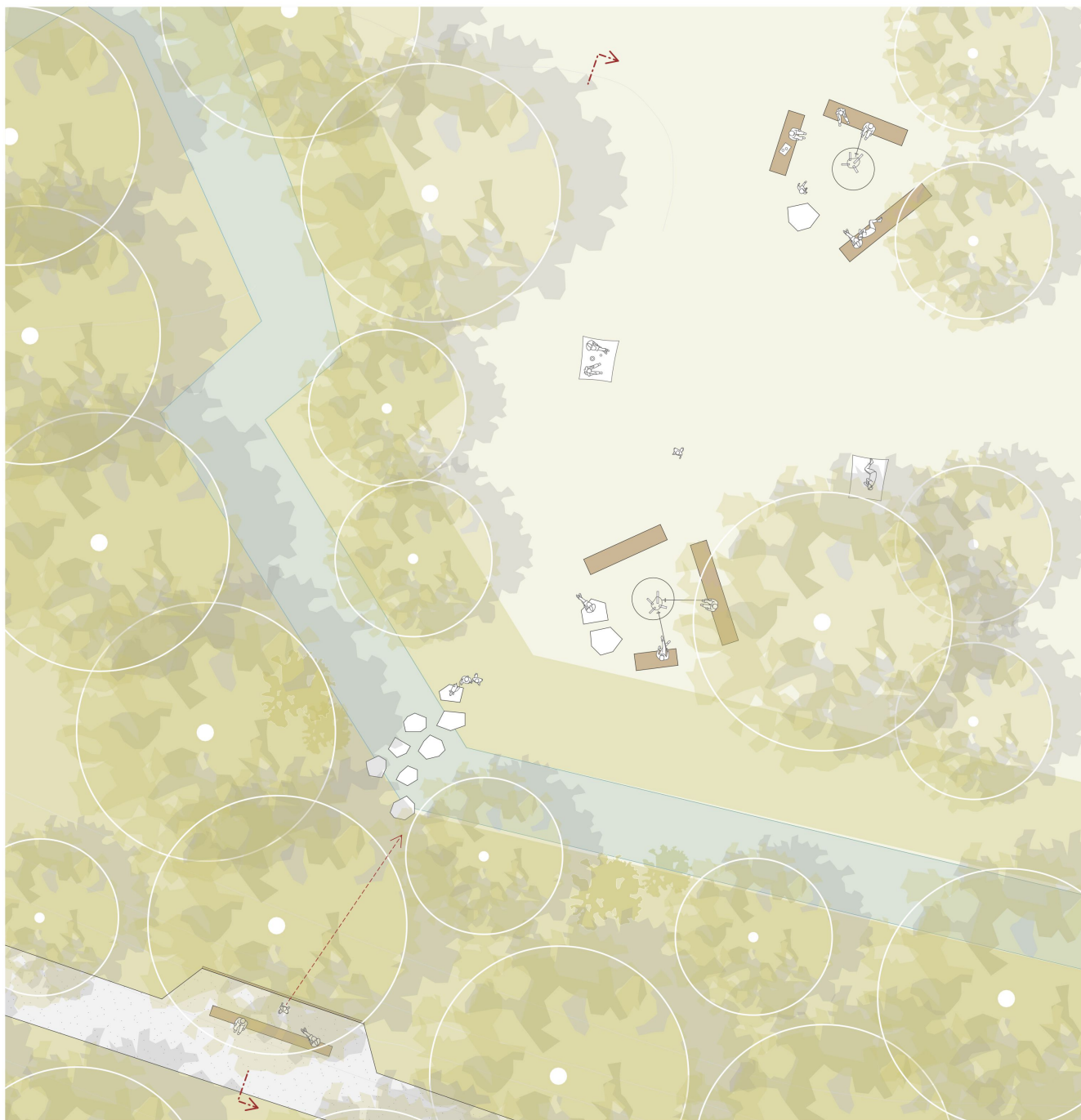

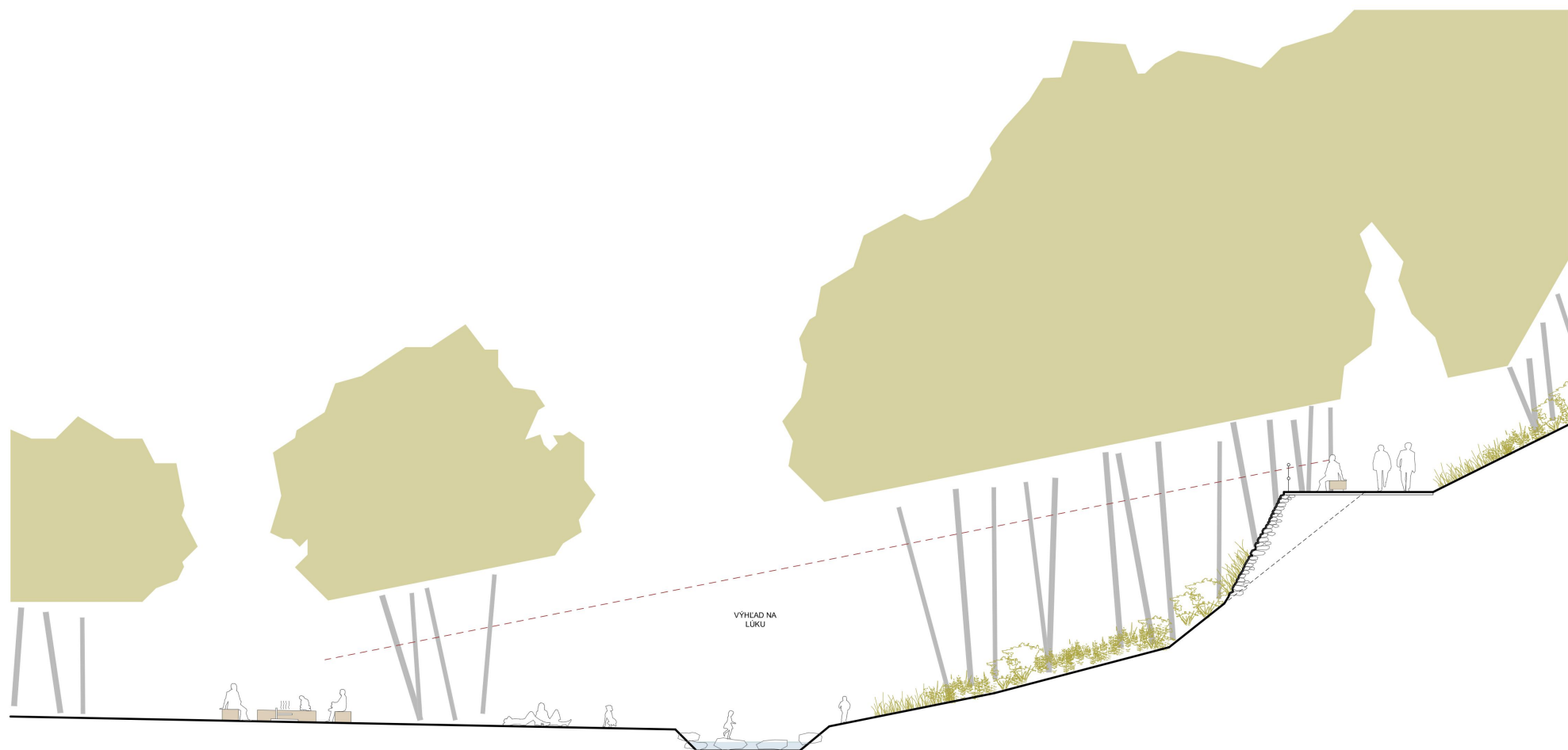



prechody cez vodu - motýv hry



kamenné šlapáky na vode



šmíklavka medzi brehmi

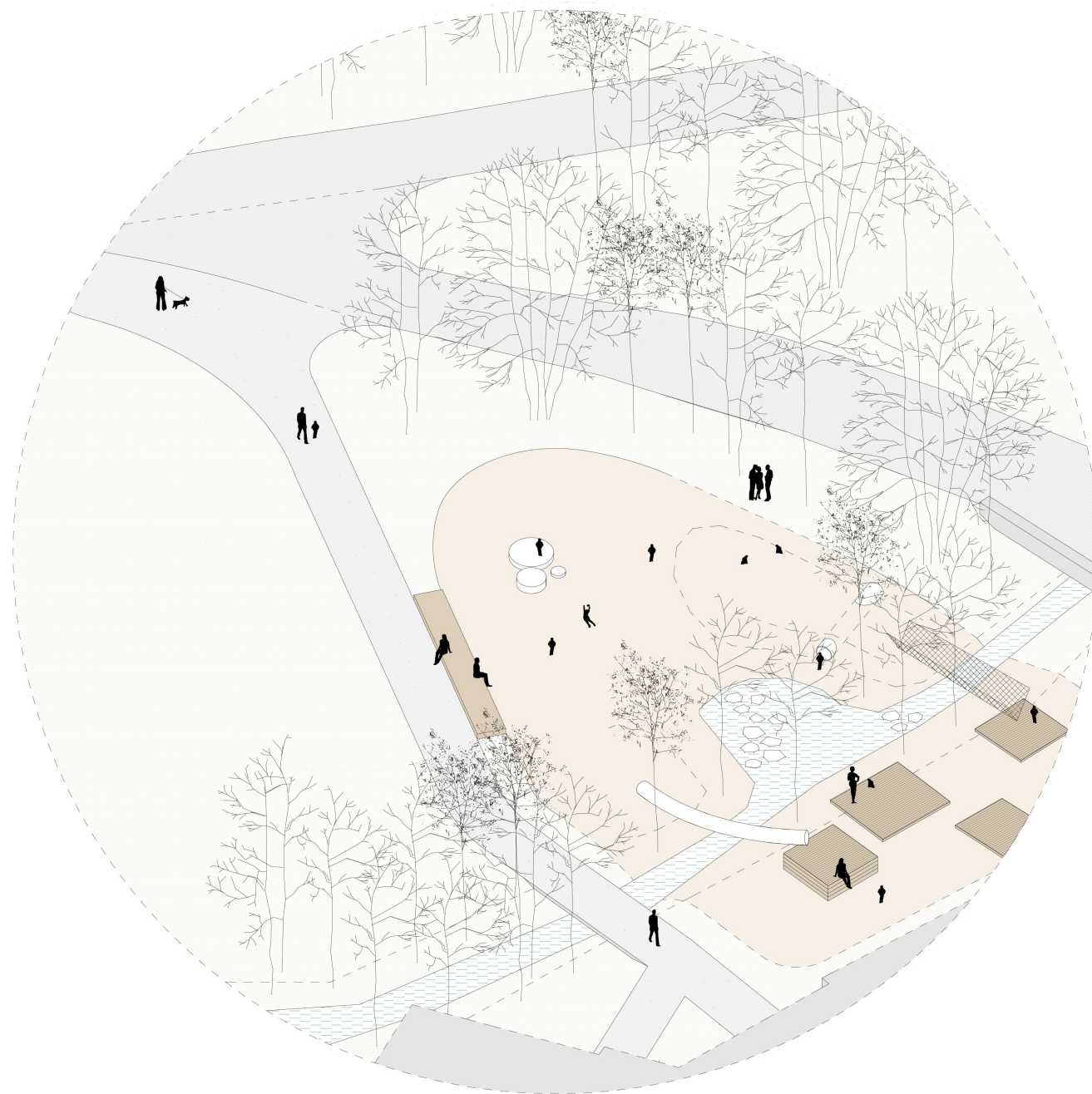

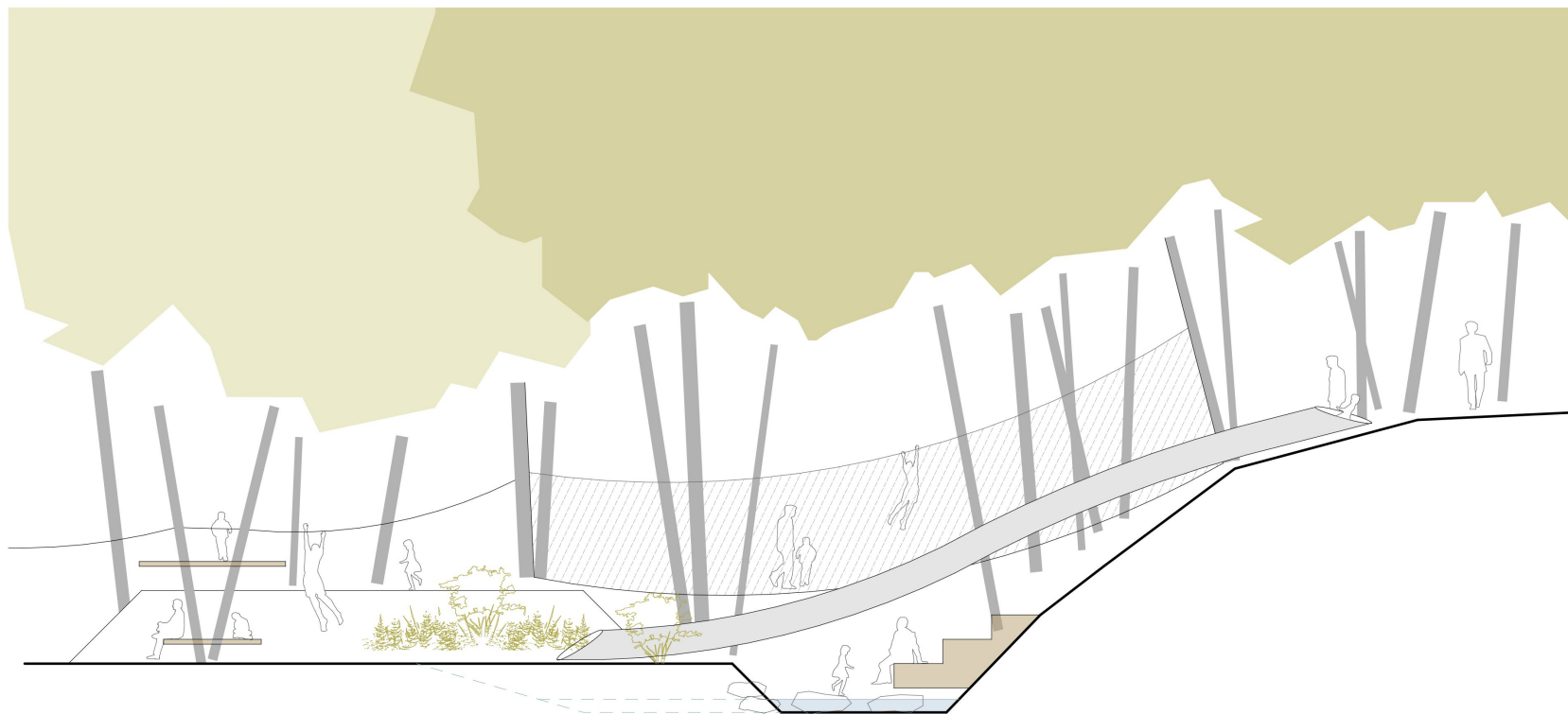

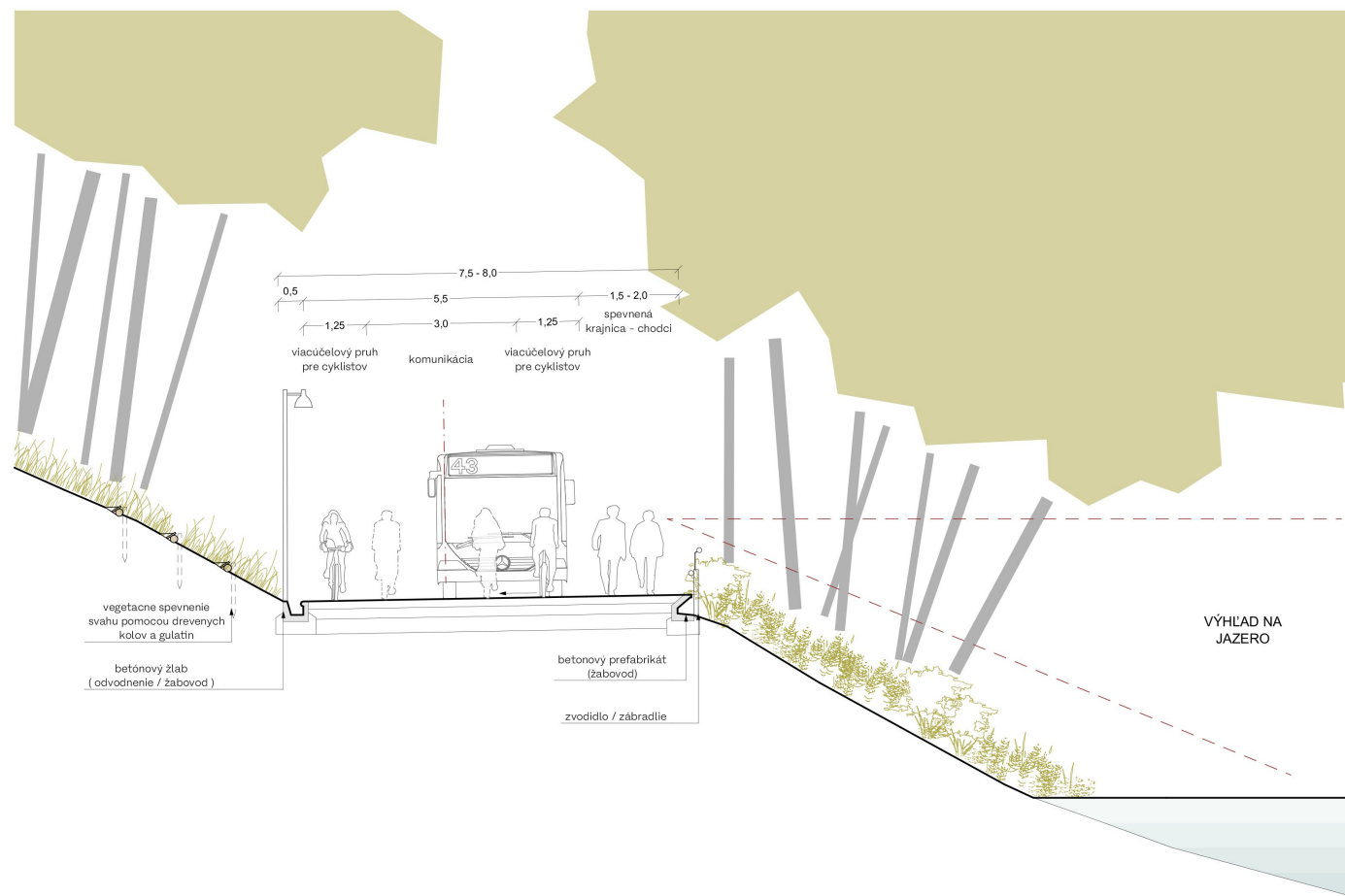





SOFT  
drevná štiepka / mlat



DREVENÁ LAVIČKA  
masív



HARD  
asfalt / mačacie hlavy



ODPADKOVÝ KÔŠ  
VESTRE - pozink  
DREVENÉ LEHÁTKA  
Drieňovská lúka



mobiliár - drevene  
latkovanie  
-  
drevený masív



PIKNIKOVÝ STÔL  
VESTRE - pozink  
STOJANY NA BICYKLE  
VESTRE - pozink



pôvodná lampa v prvej  
etape železnej studničky



navrhované osvetlenie  
novej časti  
-  
Louis poulsen Toldbod



pôvodná autobusová  
zastávka

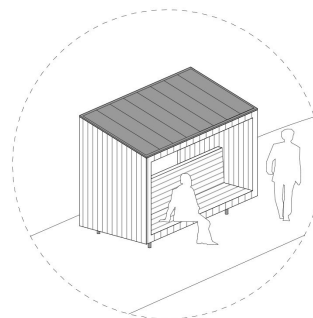

navrhovaná autobusová  
zastávka

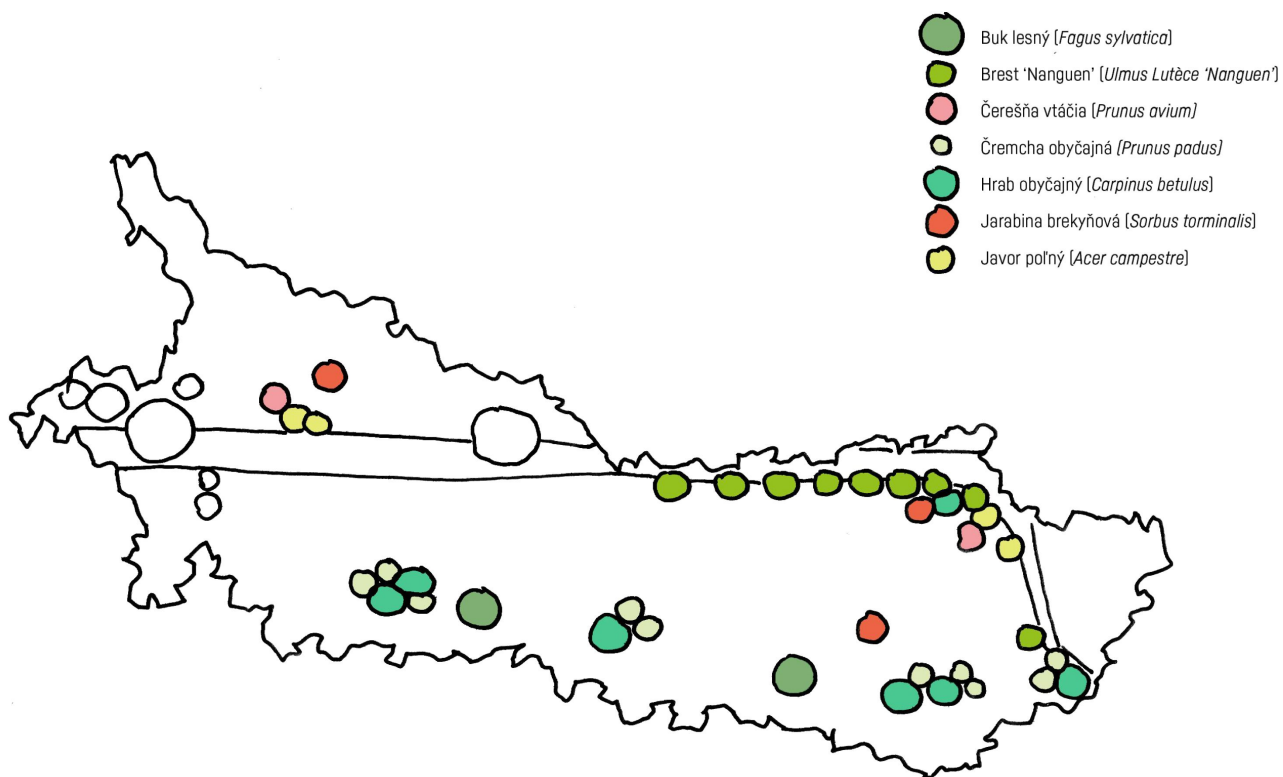



Ďakujeme

**What Architects.**

3:0 |  
LANDSCHAFTS  
ARCHITEKTUR

**PROKOS, s.r.o.**